

CHERUBINI



METAHOME



DUAL RADIO GATEWAY

EN



INSTRUCTIONS

Table of contents

Technical specifications	EN-3
Device description.....	EN-4
METAHome Gateway app for smartphones and tablets.....	EN-5
Connecting the Gateway.....	EN-5
LED status indicator	EN-5
Powering on the Gateway	EN-6
Powering off the Gateway.....	EN-6
Registration and first access to the gateway	EN-6
Local access.....	EN-8
Profile storage	EN-8
Description of the main screen	EN-9
Inclusion of a Z-Wave device.....	EN-10
Standard inclusion	EN-10
Inclusion with S2 SECURITY	EN-11
SmartStart inclusion	EN-11
SmartStart inclusion with QR-Code.....	EN-11
SmartStart inclusion with DSK code.....	EN-12
Exclusion of a Z-Wave device.....	EN-13
Pairing and unpairing a device from the 433 radio network.....	EN-14
Smart management.....	EN-16
USB update procedure	EN-16
Gateway reset.....	EN-17
Software reset	EN-17
Factory reset	EN-17
EU Declaration of conformity	EN-17

TECHNICAL SPECIFICATIONS

Power supply	5 VDC
System temperature limit	105 °C
Operating temperature	-10 °C +40 °C
Z-Wave radio frequency	868,4 MHz (Europe)
Security system (Z-Wave)	Security S0 and S2
Maximum distance (Z-Wave)	Up to 100 m outdoors Up to 40 m indoors
Compliance	CE, RoHS
Protection degree	IP 20

DEVICE DESCRIPTION

The METAHome Gateway is a home automation control unit designed to control Z-Wave devices from any manufacturer and also allows the control of Cherubini radio and dual-radio tubular motors.

The METAHome Gateway allows the control of various products intended for domestic use, such as lights, power loads, blinds, etc., which communicate via the Z-Wave protocol, Wi-Fi and 433 MHz radio.

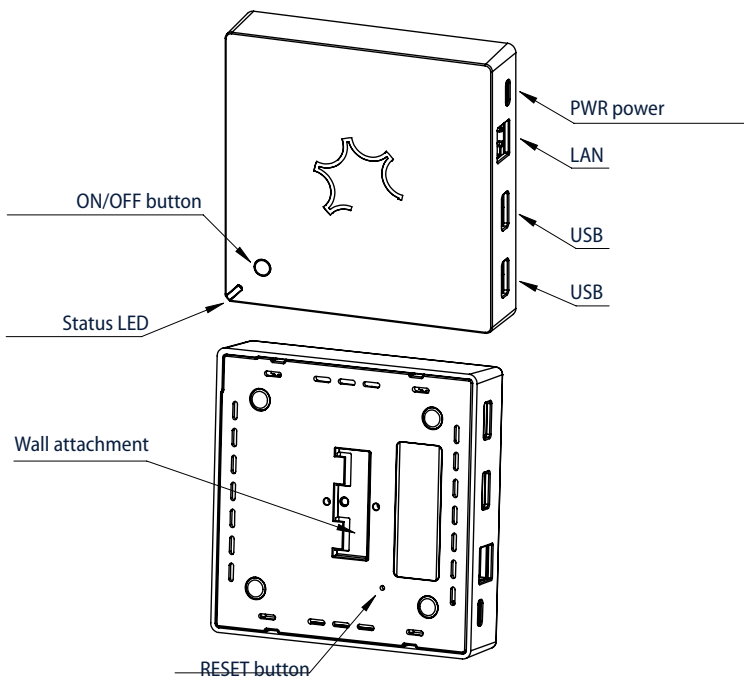

METAHOME GATEWAY APP FOR SMARTPHONES AND TABLETS

To operate the METAHome Gateway, you need to install the METAHome app on your Smartphone or Tablet.



App METAHome



CONNECTING THE GATEWAY

First, connect the device to the LAN socket via the Ethernet cable (RJ45), then connect it to the mains using its power supply.

Once connected to the mains, the Gateway will power on.

The status LED indicates the Gateway start-up phases.

LED STATUS INDICATOR

The system includes an RGB LED that indicates the status of the device during installation:

SOLID YELLOW: system starting up

Solid LIGHT GREEN: start-up complete

Blinking GREEN: system started and connected to the cloud

Blinking RED: system started but not connected to the cloud

GREEN-BLUE sequence: Z-Wave Inclusion procedure in progress

RED-BLUE sequence: Z-Wave Exclusion procedure in progress

Blinking GREEN-RED: update via USB stick

Fast blinking RED-GREEN-BLUE: updating/restoring phase in progress

POWERING ON THE GATEWAY

The Gateway powers on as soon as it is supplied with power. If it was previously turned off using the ON/OFF button on the Gateway, press and hold the ON/OFF button for approximately one second to switch it on. The LED will light up YELLOW.

After the start-up procedure, the LED turns LIGHT GREEN, then GREEN, and after a few moments starts blinking GREEN every 5 seconds, indicating that the system is fully started and that it is possible to connect to the Gateway via the App.

POWERING OFF THE GATEWAY

Press and hold the ON/OFF button on the Gateway for approximately 4 seconds until the RED LED lights up.

REGISTRATION AND FIRST ACCESS TO THE GATEWAY

Once the App has been downloaded, log in for the first time using a smartphone or tablet connected to the same LAN network as the Gateway.

The default login credentials are as follows:

User: user

Password: smarthome

At the end of the first login, you will be asked to change your password.

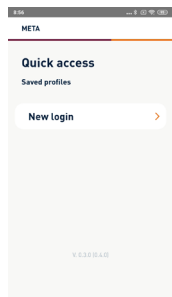

Fig. 1

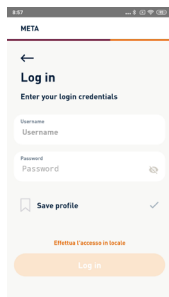

Fig. 2

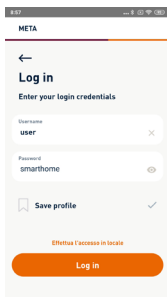

Fig. 3

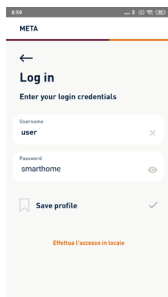

Fig. 4

By entering the default credentials and tapping the Login button (fig. 3), the App will wait for about 10 seconds (fig. 4), during which time you must press the ON/OFF button on the Gateway to accept the connection.

The LED will start blinking BLUE quickly and then GREEN quickly as soon as the connection is confirmed. It will then blink GREEN again every 5 seconds.

If the connection is not established within 60 seconds, the LED will quickly blink RED and return to blinking GREEN every 5 seconds.

At this point, you will be asked to register your data (fig. 5) and change your password (fig. 6) and then you will be taken directly to the main screen (fig. 7).

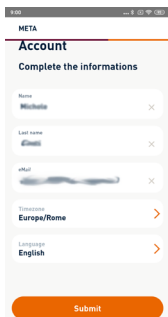

Fig. 5

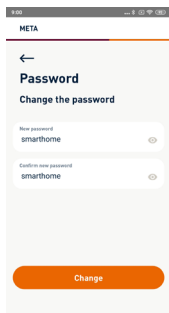

Fig. 6

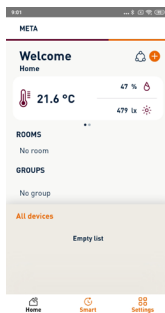

Fig. 7

LOCAL ACCESS

If the LAN does not have access to the Internet, it is possible to connect to the Gateway via local access.

By tapping “Local access” (fig. 9), you choose to access the Gateway directly via the local LAN, and you must specify the IP address assigned to the Gateway (fig. 10 and 11).

The Gateway IP address corresponds to the WS2G Gateway device listed among the devices connected to the router.

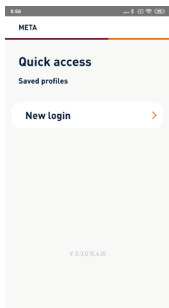

Fig. 8

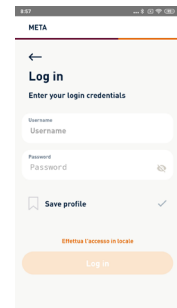

Fig. 9

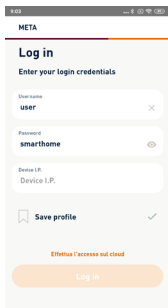

Fig. 10

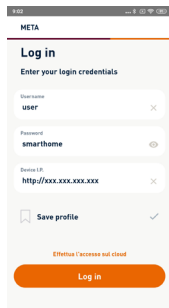

Fig. 11

PROFILE STORAGE

When registering for the first time or logging in later, you can save your profile by ticking the “Save Profile” checkbox. An additional field will then appear in which to enter the name of the profile. (fig. 12)

On subsequent logins, the name of the profile created will appear in the Quick Access screen (fig. 13 - User system).

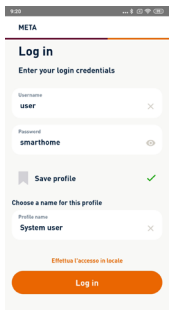

Fig. 12

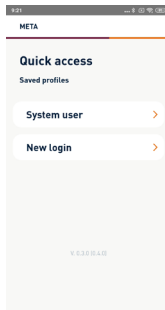

Fig. 13

DESCRIPTION OF THE MAIN SCREEN



INCLUSION OF A Z-WAVE DEVICE

Standard inclusion

On the main screen, tap the + icon to open the drop-down menu for adding new devices (fig. 14). Select the Z-Wave network, then on the next screen tap "Add device" (fig. 15).

On the next screen (fig. 16), tap Search and put the device to be included in Learning Mode (which is typically done by pressing a button on the device) and then follow the instructions on the next screens (fig. 17, 18 and 19) up to fig. 20. When the procedure is completed, the screen for inclusion/exclusion of Z-Wave devices will be displayed again (fig. 15), and it is possible to add new devices. Otherwise, it will return to the main control screen, where the added device will appear (fig. 21).

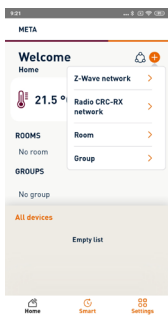

Fig. 14

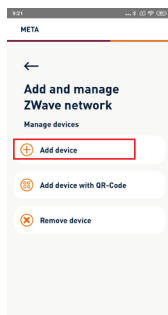

Fig. 15

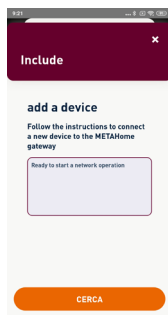

Fig. 16

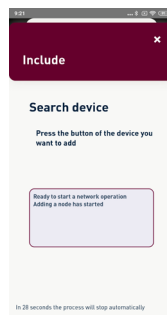

Fig. 17

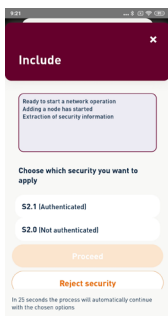

Fig. 18

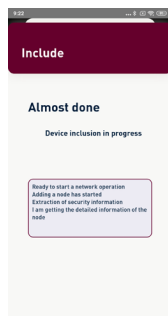

Fig. 19

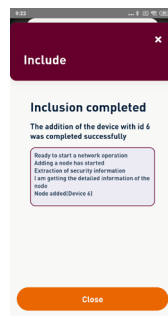

Fig. 20

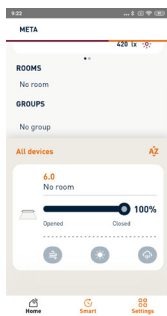

Fig. 21

Inclusion with S2 SECURITY

During standard inclusion (fig. 18), when selecting S2.1 security mode (Authenticated), you will be prompted to enter a PIN code. Devices compatible with S2.1 security have a unique DSK (Device Specific Key) printed on the product label. The first five digits of the DSK code, highlighted and underlined, identify the PIN code.

SmartStart inclusion

The METAHome Gateway supports the SmartStart feature, which enables simplified inclusion of devices in a Z-Wave network. The SmartStart function eliminates the need to operate on the device during the inclusion procedure. Inclusion is automatically started when the device is powered, and until the device is included in the Z-Wave network, the inclusion process is repeated at dynamic intervals. When the device reports that it has been powered, the Gateway will start the inclusion process in the background, without requiring user interaction. SmartStart supports the inclusion of devices with S2 security. SmartStart inclusion is performed by scanning the QR-Code or by entering the Z-Wave DSK code shown on the device to be included.

SmartStart inclusion with QR-Code

On the main screen, tap the + icon to open the drop-down menu for adding new devices (fig. 14). Select "Add device with QR-Code" (fig. 22), then on the next screen tap "Add device (QR-Code)" (fig. 23). Once the QR-Code has been scanned (fig. 24), the screen shown in fig. 25 will open, where you need to tap "Add". The device will be added to the SmartStart inclusion list (fig. 26) and will be identified by the first 5 digits of the DSK code on the device.

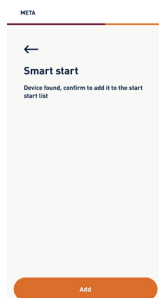
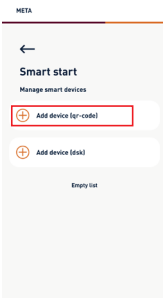
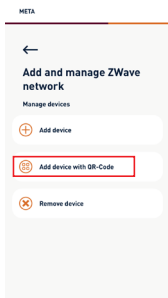

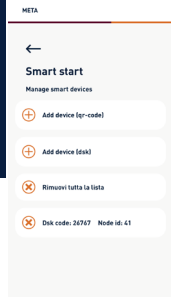

Fig. 26

SmartStart inclusion with DSK code

On the main screen, tap the + icon to open the drop-down menu for adding new devices (fig. 14). Select “Add device with QR-Code” (fig. 22), then on the next screen tap “Add device (DSK)” (fig. 27). On the next screen (fig. 28), enter the full DSK code string including digits and hyphens and tap “Add”. The device will be added to the SmartStart inclusion list (fig. 29) and will be identified by the first 5 digits of the DSK code on the device.

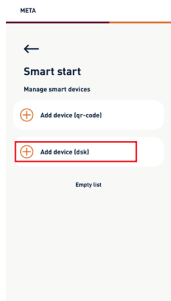

Fig. 27

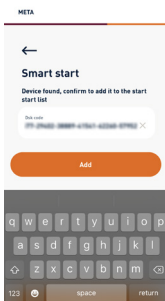

Fig. 28

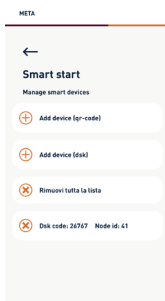

Fig. 29

EXCLUSION OF A Z-WAVE DEVICE

On the main screen, tap the + icon to open the drop-down menu for adding new devices (fig. 14). Select the Z-Wave network, then on the next screen tap “Remove device” (fig. 30).

In the next screen (fig. 31), tap Search and put the device to be excluded into Learning Mode (which is typically done by pressing a button on the device) and then wait for the procedure to complete (fig. 32 and 33). When the procedure is complete, the Z-Wave device inclusion/exclusion screen (fig. 30) is displayed, where you can remove other devices. Otherwise, you will return to the main screen.

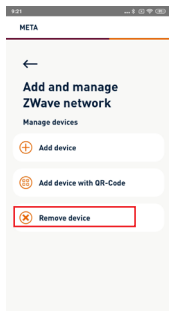

Fig. 30

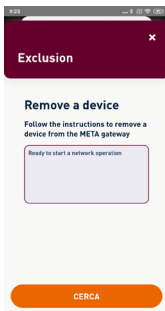

Fig. 31

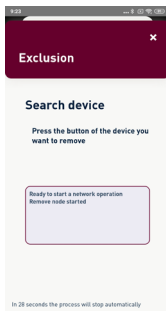

Fig. 32

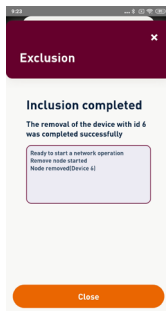

Fig. 33

PAIRING AND UNPAIRING A DEVICE FROM THE 433 RADIO NETWORK

On the main screen (fig. 34), tap the + icon to open the drop-down menu for including new devices (fig. 35). Select the CRC RX radio network and in the next screen, tap the type of device you wish to pair with the Gateway (fig. 36).

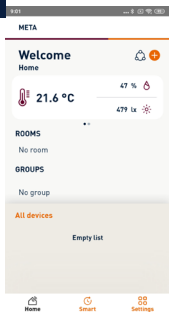

Fig. 34

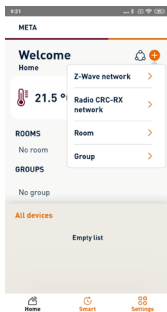

Fig. 35

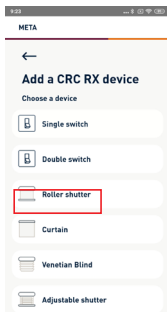

Fig. 36

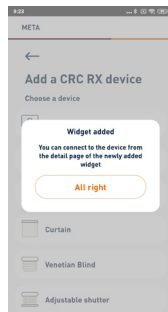

Fig. 37

Once you have tapped the device type, you must return to the main screen to display the selected device's widget (control panel) (fig. 37). In the example shown, the device chosen is a roller shutter.

Once the widget has been created, it is necessary to pair the device to be controlled. Tapping the ID number of the widget (fig. 38) takes you to the configuration menu. By tapping Advanced (fig. 39), a list of actions to be carried out as required appears (fig. 40).

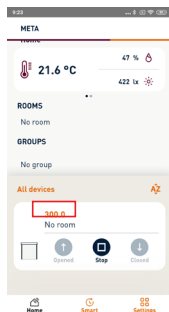

Fig. 38

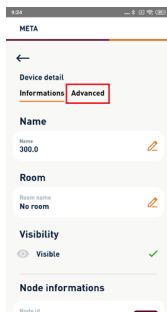

Fig. 39

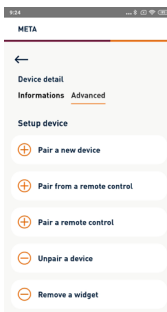

Fig. 40

Available actions are:

- Pair a new device: this action is only required when installing the device (motor or control unit) for the first time when no remote control has yet been paired with the device.
- Pair from a remote control: Use when you want to pair the META app with a device already associated with a remote control. See procedure 1 for details of using the remote control.
- Pair a remote control: to be used for a device already paired with the META app, if you want to add an additional remote control. See procedure 2 for details of remote control use.
- Unpair device: Use when you want to unpair a device from the META app. Perform this action and check that the device no longer responds to the META app before performing the next action to remove the widget.
- Remove Widget: After unpairing the device from META, use this action to remove the device from those displayed on the main screen.

PROCEDURE 1 → To execute the ADD FROM function

1. Already programmed remote control:

a. Select the desired channel and perform the following sequence:

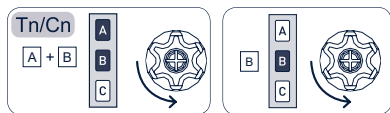

PROCEDURE 2 → To execute the ADD TO function

2. Additional remote control:

a. Select the desired channel and perform the following sequence:

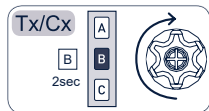

SMART MANAGEMENT

Through the Gateway, you can set up various smart scenarios according to your habits and needs, programming the operations of smart devices and the interactions between them. From the main screen (fig. 41), you can get to the Smart management screen (fig. 42), from which you can set Scenes, schedule devices to turn on and off and set rules for interaction between devices.

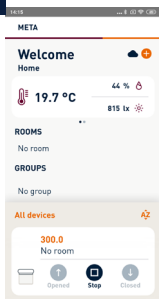

Fig. 41

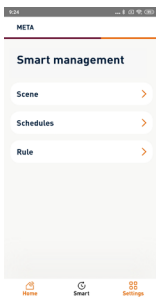

Fig. 42

USB UPDATE PROCEDURE

Switch off the Gateway.

Connect the USB stick containing the update file provided by the manufacturer and restart the Gateway by pressing the power button.

The LED will start blinking GREEN-RED as soon as the Gateway detects the update file on the USB stick. To proceed with the update, leave the USB stick inserted in the Gateway. Otherwise, remove it within 10 seconds. If you proceed with the update, the Gateway will reboot, at which point the YELLOW LED will first come on again, and after a few moments, the fast blinking RED-GREEN-BLUE will begin. Do not remove the USB stick during this step.

The Gateway will restart after the update, which may take several minutes (status LED YELLOW). At this point, remove the USB stick to allow the Gateway to boot up normally and avoid repeating the update.

GATEWAY RESET

Using the RESET button located on the bottom of the Gateway, it is possible to perform two types of resets.

Software reset

This reset allows the Gateway software to be restored without deleting user data and associated devices.

After switching off the Gateway, switch it on again while holding down the RESET button. Release the button two seconds after the BRIGHT YELLOW LED lights up. After approximately one minute, the status LED will start blinking rapidly RED-GREEN-BLUE, indicating that the procedure is in progress.

During the reset, the Gateway may restart several times. The procedure is completed when the LED on the Gateway blinks regularly every 5 seconds.

Factory reset

This reset results in the deletion of all Gateway data and the restoration of the software. With the Gateway powered on and the LED blinking every 5 seconds, press and hold the RESET button for approximately 15 seconds. Release the button when the LED on the Gateway starts blinking rapidly in RED.

The Gateway will restart and, subsequently, the status LED will start blinking rapidly RED-GREEN-BLUE, indicating that the procedure is in progress.

During the reset, the Gateway may restart several times. The procedure is completed when the LED on the Gateway blinks regularly every 5 seconds.

EU DECLARATION OF CONFORMITY

CHERUBINI S.p.A. declares that the product is in conformity with the relevant Union harmonisation legislation: Directive 2014/53/EU, Directive 2011/65/EU.

The full text of the EU declaration of conformity is available upon request at the following website: www.cherubini-group.com.

Failure to comply with these instructions annuls CHERUBINI's responsibilities and warranty.

**CHERUBINI S.p.A.**

Via Adige 55
25081 Bedizzole (BS) - Italy
Tel. +39 030 6872.039
info@cherubini.it | www.cherubini.it

CHERUBINI Iberia S.L.

Avda. Unión Europea 11-H
Apdo. 283 - P. I. El Castillo
03630 Sax Alicante - Spain
Tel. +34 (0) 966 967 504
info@cherubini.es | www.cherubini.es

CHERUBINI France SAS

ZI Du Mas Barbet
165 Impasse Ampère
30600 Vauvert - France
Tél. +33 (0) 466 77 88 58
info@cherubini.fr | www.cherubini.fr

CHERUBINI Deutschland GmbH

Rotter Viehtrift 4A - 53842 Troisdorf - Deutschland
Tel. +49 (0) 224 126 699 74 | Fax +49 (0) 224 126 699 73
info@cherubini-group.de | www.cherubini-group.de